

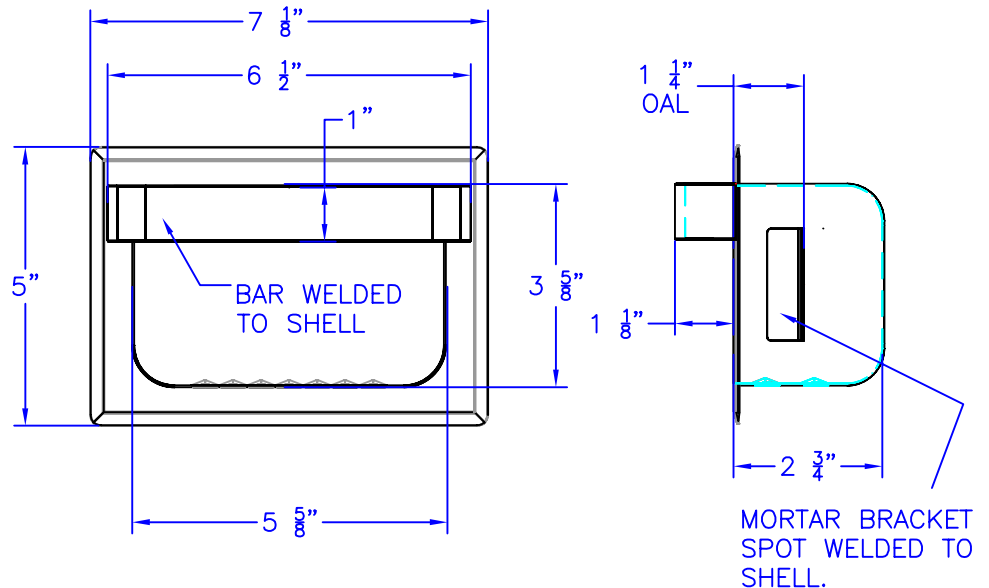

Technical Data

S-2633-XX

HEAVY DUTY RECESSED SOAP DISH



FINISH CODE
 -SS = SATIN FINISH
 -BS = BRIGHT FINISH

Construction:

SOAP DISH: 20 GAUGE TYPE 304 STAINLESS STEEL, ONE PIECE SEAMLESS.
 BAR: 7 GAUGE TYPE 304 STAINLESS STEEL WELDED TO SHELL.
 MORTAR BRACKET: 22 GAUGE TYPE 304 STAINLESS STEEL WELDED TO SHELL.

Installation:

REQUIRES A ROUGH WALL OPENING 6" WIDE X 4" HIGH X 2 3/4" DEEP.
 MOUNT AT DESIRED LOCATION USING THE MORTAR BRACKETS FOR ANCHORING IN CEMENT.

Guide Specification:

HEAVY DUTY RECESSED SOAP DISH FABRICATED OF TYPE 304 STAINLESS STEEL, DRAWN SEAMLESS CONSTRUCTION, EQUIPPED BAR.
 OVERALL EXPOSED FACE DIMENSION: 5" X 7 1/8".
 INSIDE DIMENSION 5 5/8" WIDE X 3 5/8" HIGH X 2 3/4" DEEP.

The manufacturer reserves the right to make changes in design and material without formal notice and without incurring obligation

© Copyright 2005
 Brey-Krause Manufacturing

Brey-Krause Manufacturing
 1209 West Lehigh Street, Bethlehem, PA 18018
 Phone: 610.867.1401 Fax: 610.866.1433
 www.breykrause.com